

Strzegom

CCIO4*-NC-S

Strzegom, Poland

JUNE 25-28, 2026

Untargeted
Team Event



Disclaimer: This Playbook is a resource produced by the USEF Eventing Department. Please visit the event's [official website](#) for the most up to date information.

SPONSORS

US EQUESTRIAN TEAM



Thank you to our generous sponsors who help our Teams compete at the FEI Nations Cups:

USET Foundation and its generous donors

USOPC

USEF Sponsors and Members

For a full list of USEF Sponsors please visit: www.usef.org

THIS PLAYBOOK IS PRODUCED BY THE USEF EVENTING DEPARTMENT.

IOC – International Olympic Committee

USEF – United States Equestrian Federation

USET – United States Equestrian Team Foundation

USOPC – United States Olympic and Paralympic Committee

USADA – United States Anti-Doping Agency

Disclaimer: This Playbook is a resource produced by the USEF Eventing Department. Please visit the event's [official website](#) for the most up to date information.

Table of Contents

INTRODUCTION.....	4
APPLICATIONS	5
ENTRIES	5
APPLICATION AND SELECTION TIMELINE.....	5
SELECTION PROCEDURES	5
FUNDING	5
PRE-TRAVEL INFORMATION	6
VISAS	6
VACCINATIONS	6
TRAVEL INFORMATION.....	6
EQUINE TRANSPORTATION	6
HUMAN TRANSPORTATION.....	7
HUMAN ACCOMMODATION	7
CAR SERVICE INFORMATION	7
USA EVENTING GUIDE TO TRAVELING OVERSEAS	7
ACCREDITATION.....	7
APPAREL	8
TICKETS.....	8
VENUE	8
STABLES	8
TACK ROOMS.....	8
COMPETITION SCHEDULE	8
TEAM STAFF.....	8
SAFE SPORT, CODE OF CONDUCT, & CLEAN SPORT	8
HORSE	9
ATHLETE.....	9
PRESS & MEDIA	9
SOCIAL MEDIA.....	9
HOSPITALS & EMERGENCY SERVICES.....	9
INCIDENT MANAGEMENT GUIDELINES.....	9

Disclaimer: This Playbook is a resource produced by the USEF Eventing Department. Please visit the event's [official website](#) for the most up to date information.

ABOUT STRZEGOM.....	11
LANGUAGE	11
ELECTRICAL.....	11
TELEPHONES, WI-FI, AND INTERNET ACCESS.....	11
WEATHER	11
FOOD AND LOCAL RESTAURANTS	12
LOCAL BUSINESS HOURS	12
GETTING AROUND THE TOWN.....	13
CURRENCY AND EXCHANGE.....	13
CREDIT CARDS	13
TIPPING	13
TRAVELERS CHECKS	13

Disclaimer: This Playbook is a resource produced by the USEF Eventing Department. Please visit the event's [official website](#) for the most up to date information.

UNTARGETED NATIONS CUP: STRZEGOM

US EQUESTRIAN TEAM PLAYBOOK

INTRODUCTION

The aim of the Playbook is to give those who are attending the Strzegom (POL) CCIO4*-NC-S an understanding of the logistical support that is available through USEF. As an Untargeted Nations Cup, please note that the Team will not receive funding, apparel, Team Staff support, or expense reimbursements.

As with any Nations Cup, Strzegom will have its challenges and differences from other Events. The emphasis must be on ensuring our athletes, horses, and grooms can perform their very best. A performance environment must be maintained and always keep in mind that even if you are not on a U.S. Eventing Team, you are still representing the USA at these European competitions.

The competition venue is approximately 50 minutes southwest of Wrocław and will be hosting additional levels and divisions. This is not a stand-alone Nations Cup and additional divisions will run alongside the CCIO4*-NC-S. Please review the published [FEI Schedule](#) for the available divisions and their restrictions.

We are continually receiving updates and new information so this playbook can never cover all the details. The primary point of contact is Christina Vaughn, and her contact information can be found below.

This playbook contains helpful information for attending this Event. Please also familiarize yourself with the [FEI Schedule](#) and remember to check in at the show office upon arrival for the most up-to-date information.

PLEASE READ THIS PLAYBOOK AS IT CONTAINS IMPORTANT INFORMATION ABOUT TRAVEL PLANNING, CLIMATE, AND ACCOMMODATIONS.

Please contact Christina if you have any questions, observations, or suggestions as to how we can optimize the support of the athletes, grooms, and horses.

Good luck to all!

Christina Vaughn

Christina Vaughn
Director, Eventing Elite Programs
T: +1 (859) 225-6917
E: cvaughn@usef.org

Disclaimer: This Playbook is a resource produced by the USEF Eventing Department. Please visit the event's [official website](#) for the most up to date information.

APPLICATIONS

ENTRIES

In the [USEF Athlete Dashboard](#), athletes must complete both an Online Application and an FEI Entry.

Online Applications are required for selection to a Team. The Online Application section allows athletes to apply for selection to a CCIO at which the U.S. will field a Team. This process is managed by USEF Eventing. Additionally, as an untargeted Nations Cup, **the Athlete will also need to submit an entry through the FEI Entry System.** If a Team is named for this event, USEF will pay for the Nations Cup Entry Fee.

An FEI Entry is required to compete as an Individual. Athletes must submit the FEI Entry in order to be entered into the FEI Entry System to compete as an individual at any FEI competition, whether in the U.S. or abroad. The FEI Entry process is managed by US Equestrian Athlete Services.

Entries must be paid as outlined in Section VII of the [FEI Definite Schedule](#).

APPLICATION AND SELECTION TIMELINE

Applications Open: January 1, 2025, at 9:00 a.m. EST

Application Close and Team Selection: Event entries and applications will be monitored to determine if there is enough interest to field a U.S. Team. If you are interested in being considered for the Team, please get in touch with Christina Vaughn at cvaughn@usef.org or +1 (859) 225-6917 for the next steps.

SELECTION PROCEDURES

As an Untargeted Nations Cup, the Strzegom Nations Cup team follows the [2026 Untargeted Team Opportunities Selection Procedures](#).

FUNDING

As an Untargeted Nations Cup, Athletes named to the Strzegom Nations Cup U.S. Team will not receive funding.

USEF will cover the National Federation fee and FEI Entry fee for the Team.

PRE-TRAVEL INFORMATION

VISAS

Due to start in 2025, U.S. citizens and non-E.U. nationals will need to complete the Entry/Exit System (EES) for all short-term stays in European countries. Registration and biometric data collection will be completed at a border control kiosk at the arrival airport. More information about EES can be found [here](#). It is the traveling individual's responsibility to check any visa requirements.

VACCINATIONS

In accordance with the CDC and USOPC recommendations, we advise that all Athletes, grooms, and traveling USEF support staff consider getting the new COVID vaccine now available against new strains as well as the seasonal flu vaccine. These vaccines can be administered at the same time. This is NOT a USOPC or USEF requirement, but it is highly recommended to protect our athletes, grooms, and all Team members. Please note it takes approximately two (2) weeks to maximize immunity.

TRAVEL INFORMATION

EQUINE TRANSPORTATION

It is the athlete's responsibility to organize their horse's travel to the event. Christina Vaughn is available for assistance.

USA to POL: Dutta Horse Transport Inc is the preferred USEF vendor for horse flights departing the continental United States.

- [Website](#)
- Phone: +1 (914) 276 3880
- Email: info@timdutta.com

Ground Transportation: Gelissen's Horse Transport is the preferred USEF vendor for ground transportation within Germany.

- [Website](#)
- Phone: +31 (0)46 437 35 74
- Email: info@horse-transport.nl

POL to USA: Guido Klatte GmbH & Co.KG is the preferred USEF vendor for horse flights departing Germany.

- [Website](#)
- Phone: +49 (0) 44 72 / 94 00 70
- Email: guido@gklatte.de

Disclaimer: This Playbook is a resource produced by the USEF Eventing Department. Please visit the event's [official website](#) for the most up to date information.

Hay/Bedding: Please refer to the [FEI Schedule](#) for hay/bedding that is available at the venue.

HUMAN TRANSPORTATION

All athletes, grooms, and owners are responsible for booking their own travel itinerary. Below is a list of recommended airports to Wrocław.

Port Lotniczy Wrocław S.A. (WRO) has one terminal that operates both international and domestic flights. It is approximately 36 miles (40 minutes) from the competition venue.

HUMAN ACCOMMODATION

There are many local accommodation options. Below is a non-extensive list of nearby hotels. It is the traveling individual's responsibility to book their accommodation.

Requests for groom's accommodation must be sent with the entries.

Hotel	Website	Distance
Best Western Park Hotel	Click here	3.5 mi
Hotel Relax Roma Nord	Click here	4.1 mi
Hotel Palace Inn Fiano Romano	Click here	4.3 mi
Hampton By Hilton Rome North Fiano Romano	Click here	5.0 mi
Quality Hotel Green Palace	Click here	8.0 mi

CAR SERVICE INFORMATION

Public Transport: There is public transport in Wrocław however public transportation is not accessible to or from the competition venue.

Taxi: Taxis use meters calculated by distance and time.

Rental Vehicles: For automatic vehicles, it is recommended to book a rental car with a large rental agency.

USA EVENTING GUIDE TO TRAVELING OVERSEAS

To view the USA Eventing Guide to Traveling Overseas click [here](#).

ACCREDITATION

Please review the [FEI Schedule](#) for the most up-to-date information on available accreditations.

Disclaimer: This Playbook is a resource produced by the USEF Eventing Department. Please visit the event's [official website](#) for the most up to date information.

APPAREL

As an Untargeted Nations Cup, athletes, grooms, and owners will not receive horse or human apparel from USEF.

TICKETS

Tickets will not be sold for spectators to attend the event.

VENUE

The equestrian venue is southwest of the center of Wrocław.

The venue address is **Morawa 36, 58-150 Strzegom, Poland**

STABLES

Stable boxes are 3m x 3m.

TACK ROOMS

Tack rooms are available on request. It is the Athlete's responsibility to coordinate with the entry.

COMPETITION SCHEDULE

The full schedule for the Strzegom Horse Trials can be found [here](#).

TEAM STAFF

As an Untargeted Nations Cup, Eventing Team Staff are not available for the duration of the competition.

SAFE SPORT, CODE OF CONDUCT, & CLEAN SPORT

Similar to any USEF licensed Event, SafeSport, the USEF Code of Conduct and Clean Sport must be abided by at all times.

Click [here](#) for SafeSport Information

Click [here](#) for USEF Code of Conduct

Click [here](#) for Clean Sport Information

Disclaimer: This Playbook is a resource produced by the USEF Eventing Department. Please visit the event's [official website](#) for the most up to date information.

HORSE

Once a horse is named to a Team all communication regarding treatments and medications is to be directed to the team veterinarian. No medications can be transported with the horses.

ATHLETE

Once an athlete is named to a Team it is important that any Therapeutic Use Exemptions (TUEs) are up to date and with the athlete at all times. If there are any questions regarding medications please reach out to Steven Morrissey (smorrissey@usef.org) or Dr. Mark Hart (markvhart@gmail.com).

PRESS & MEDIA

SOCIAL MEDIA

Social media can be a great advantage for athletes, but it can also be detrimental to the Team and to the environment. Please familiarize yourself with the policies below.

The FEI Social Media policy can be found [here](#).

The USEF Social Media policy can be found [here](#).

If you have any questions about the utilization of social media during the Nations Cup, please contact Sr. Director Social Media & Sport Communications, Carly Weilminster (cweilminster@usef.org).

HOSPITALS & EMERGENCY SERVICES

Name	Address	Phone
Kite. Regional Hospital SPZOZ	Leśna 27/29, 58-100 Świdnica, Poland	+48 74 630 60 60
Specjalistyczny Szpital im. dr Alfreda Sokołowskiego w Wałbrzychu.	Alfreda Sokołowskiego 4, 58-309 Wałbrzych, Poland	+48 74 648 97 42
Wojewódzki Szpital Specjalistyczny w Legnicy	Iwaszkiewicza 5, 59-220 Legnica, Poland	+48 76 721 11 00

Polish Emergency Services – 112

INCIDENT MANAGEMENT GUIDELINES

In general, Strzegom, POL is a safe country for its residents and visitors. However, security perception changes greatly by district. If you have any doubts or need to report an incident, you can rely on the Police.

Responsible care should be exercised when traveling throughout Poland. There is a normal level of crime in Strzegom, but it varies by district. Travelers should keep valuables out of sight and be aware of their surroundings. Avoid isolated areas when on foot, especially after dark. It is recommended to only use a trusted taxi or an app-based taxi service. Do not hail a taxi on the street.

Assailants usually target victims for their smartphones, wallets, or purses. If confronted by someone with a weapon, it is best not to resist.

It is best to use ATMs inside banks instead of ATMs that are more accessible to passers-by and all banks advise customers to cover ATM keypads with their hands when entering codes. When making credit card transactions, travelers should expect the vendor to use a credit card reader in their presence.

There is a threat of low-level crime such as mugging and theft. Security is not a worry, but all should be aware and take realistic precautions.

Security is the responsibility of everybody. However, security concerns must not be allowed to prevent Athletes from concentrating on preparing and competing their horses. Good security is the application of common sense.

The key to good security is vigilance. Be aware of what is happening around you and always pay attention to anything that appears unusual or out of place. This includes people who appear nervous about their surroundings.

- Make a copy of your passport and travel documents and leave the original in a safe place.
- Always travel in groups.
- Do not overtly wear expensive jewelry.
- Keep your phone hidden.
- Do not carry excessive amounts of cash or credit cards if you do not need them.
- If you are in a vehicle in standstill traffic with the windows rolled down, keep phones and other possessions low and away from windows and be mindful of people walking through the traffic.
- Do not approach unattended bags, cases, or packages – report them.
- Do not accept packages from anyone, the contents of which are unclear.
- Do not advertise where members of Team USA are staying.
- If you are out in the evening and you become aware of increased police activity, leave the area immediately.
- If you see an incident involving the police, do not get involved. Do not play the good Samaritan.
- Avoid wearing Team USA kits outside protected areas.

Disclaimer: This Playbook is a resource produced by the USEF Eventing Department. Please visit the event's [official website](#) for the most up to date information.

TELEPHONE NUMBER FOR THE POLISH POLICE – 112

ABOUT STRZEGOM

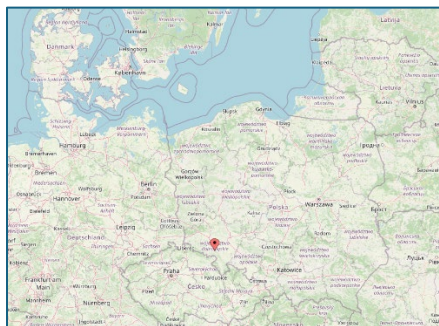

Strzegom is located in southwestern Poland within Świdnica County and is about 1 hour (36 miles) west of Wrocław. It is a small town of 16,106 people and has a deep historical significance relating back to the Roman Empire and the Middle Ages. More information about Świdnica County can be found [here](#).

LANGUAGE

Polish is the official language and most widely spoken language in Poland, which 95% of the population speak. English is the second language spoken which a little under 20% of the of the population speak.

ELECTRICAL

Power in Poland operates on a 230-volt current and a 50 hertz frequency. Electricity will be supplied through a Type C (rounded two-prong) or Type E (rounded two-prong with earthing pin).

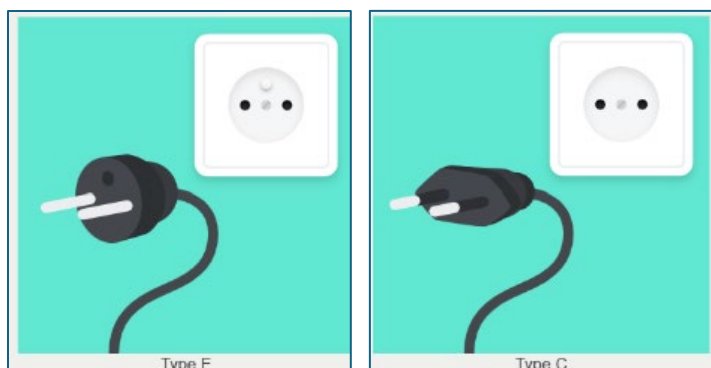

TELEPHONES, WI-FI, AND INTERNET ACCESS

Cellphone reception is typically good. Most of the country is covered with 5G systems. Contact your phone provider for more information on Sim Cards and International Data Plans.

WEATHER

Average weather for June

- High Temperature: 68°F

Disclaimer: This Playbook is a resource produced by the USEF Eventing Department. Please visit the event's [official website](#) for the most up to date information.

- Low Temperature 53°F
- Rainfall: 2.9"
- Humidity: 65%

Suggested Clothing: June is considered spring for Strzegom and can see some rainfall. It is recommended to bring layers and at least one waterproof jacket.

FOOD AND LOCAL RESTAURANTS

While tap water is considered safe to drink in Poland, it is best practice to utilize bottled water instead. Stay away from raw foods and un-bottled drinks, unless in a reputable restaurant as a precaution.

Polish cuisine heavily consists of meat, vegetables, spices, and herbs. Traditional dishes in Poland are known to be complex and take time to prepare properly. Dishes are also known to include soups, stews, and dumplings.

Some popular dishes include:

- Bigos
- Flaki
- Pierogi
- Kotlet Schabowy
- Tatar
- Gołąbki
- Rosół

There are many local restaurant options. Below is a non-extensive list of nearby restaurants.

Restaurant	Address	Distance
Zajazd	58-150 Strzegom, Poland	1.4 mi
Pod Rumakiem. Organizacja imprez okolicznościowych	Kasztelańska 20, 58-150 Strzegom, Poland	2.4 mi
Restauracja Bohun	Ignacego Paderewskiego 2, 58-150 Strzegom, Poland	2.7 mi
STRZEGOM Pizzeria pod Kasztanem	Tadeusza Kościuszki 2, 58-150 Strzegom, Poland	2.8 mi
Restauracja Pizzeria "Koba"	Bracka 8C, 58-150 Strzegom, Poland	2.9 mi

LOCAL BUSINESS HOURS

Office hours are Monday through Friday from 8:00 a.m. to 4:00 p.m. or 9:30 a.m. to 5:00 p.m.

Banks vary in operating hours. Most are open 9:00 a.m. to 4:00 or 6:00 p.m. and in larger cities, 9:00 a.m. to 1:00 p.m. on Saturday.

Disclaimer: This Playbook is a resource produced by the USEF Eventing Department. Please visit the event's [official website](#) for the most up to date information.

Shopping centers tend to be open from 10:00 a.m. to 10:00 p.m.

GETTING AROUND THE TOWN

There are apps that can be utilized in the town of Strzegom to request a vehicle such as Uber, Lyft, Ola, and Didi to name a few.

The advised and safest method of travel is by taxi or car arranged by a hotel.

CURRENCY AND EXCHANGE

The Polish złoty (PLN) is the official currency of Poland. The symbol for the złoty is zł. The złoty is sometimes referred to as “zet.” There are a few different currency exchange services within Strzegom such as, Walczak Roman. Kantor wymiany walut and Szulc Monika. Kantor wymiany walut.

Currency slang includes but is not limited to:

- 1 złoty – “Ziko”
- 2 złote – “Dwójka”
- 5 złote – “Piątak”
- 10 złote – “Dycha”
- 20 złote – “Dwie dychy”
- 100 złote – “Stówka”

CREDIT CARDS

Major credit cards are widely accepted. Use of debit cards is widespread, although some stores may impose a minimum per debit card purchase, and service charges may apply.

Money can be exchanged at the airport, exchange houses or banks.

TIPPING

Restaurants: Tipping is optional although considered customary at sit-down restaurants in Poland at a 10% rate.

Transport: Tipping taxi drivers is common for longer journeys at a 10% rate. For shorter journeys it is common to round up to the nearest significant amount of złotys.

Hotels: Tipping at hotels is customary at a 10% - 20% rate.

TRAVELERS CHECKS

Traveler's checks are not commonly used in Poland. It is best to use an ATM card at the many ATM locations available in Strzegom in the absence of cash.